

MFA3520-CM1S

Type	MANUAL MONO		Mount	C		
Focal Length	35mm		Back Focus	18.06mm		
Fno.	F2.0		Mechanical Bf	13.5mm		
Designed Image Format	2/3"(6.6x8.8mm)		Exit Pupil	-33.98mm		
Operation Range	Iris	F2.0-22	Filter Size	-		
	Focus	0.25m ~ ∞	Aperture	Front	∅17.8mm	
	Zoom	-		Rear	∅11.8mm	
Control	Iris	Manual	TV Distortion	-0.02%		
	Focus	Manual		Vignetting	-29%	
	Zoom	-				
Object Size at MOD	33.6 x 46.2mm		Dimension	∅29x38.5mm		
	-		Weight	55g		
Field of View	V	10.4°	1/2"	7.8°		
	H	2/3" 14.3°		10.4°		
	D	17.8°		13.0°		
Operating Temperature	-10°C ~ +50°C					

DIMENSIONS

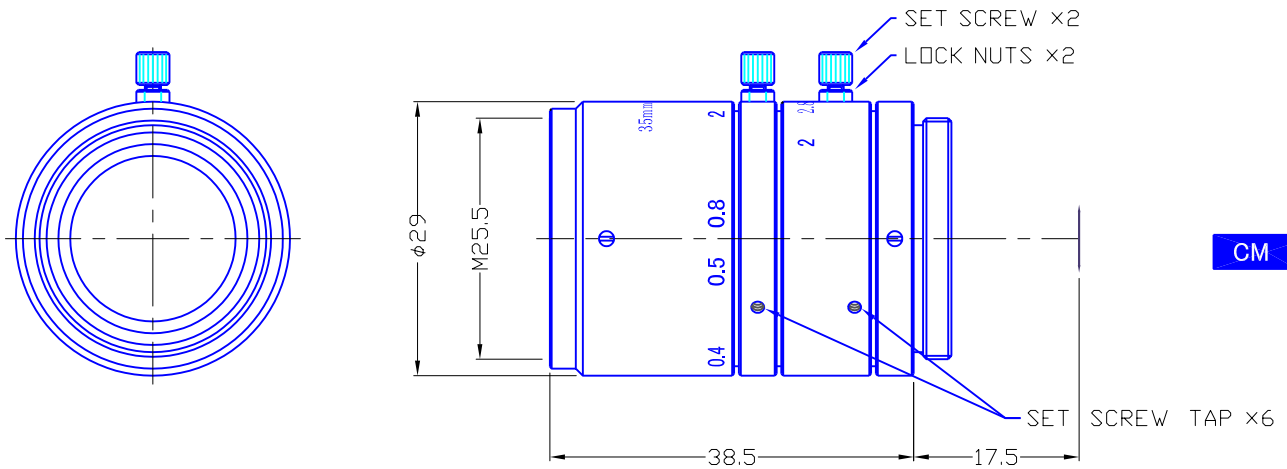

MAGNIFICATION

() : 14" MONITOR TV	O/I = 2000mm : -0.01804X (0.58X)	O/I = 400mm : -0.10391X (3.36X)
	O/I = 800mm : -0.04737X (1.53X)	O/I = 300mm : -0.14879X (4.81X)
	O/I = 500mm : -0.07997X (2.59X)	O/I = 250mm : -0.19046X (6.16X)